



maevi 

Smart Gateway

Quick Start Guide

Table Of Contents

Introduction	1
Get to know your device	1
Get Started	3
Configure Gateway Steps For Android User	4
Configure Gateway Steps For IOS User	6
Reset Gateway	8
Reset Wi-Fi Network	8
Gateway Workaround Method 1: Via Hotspot	8
Gateway Workaround Method 2: Via Create Guest Wi-Fi Network	9

Introduction

The gateway is the brain of the Maevi Smart Home system. It connects your smartphone, via Maevi app, to our smart devices allowing you monitor, automate and control your smart home anytime, anywhere.

Get to know your device

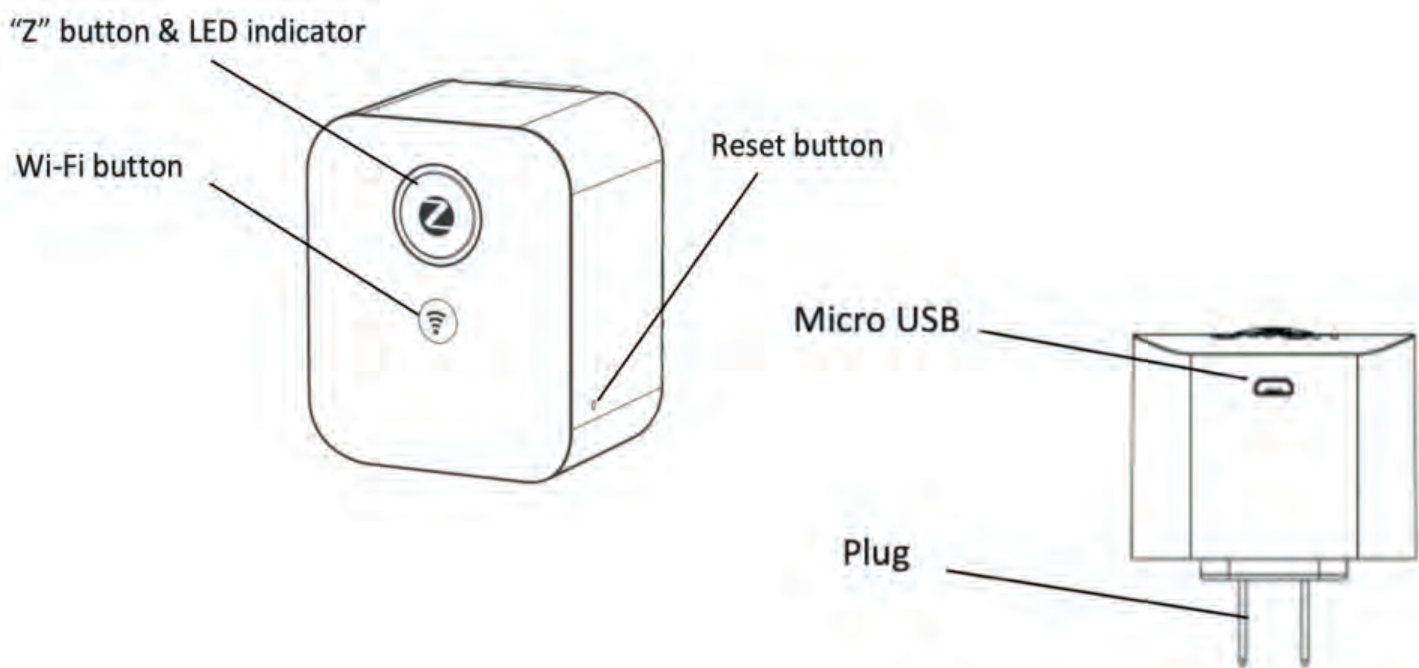

Buttons

"Z" Button	Use the "Z" button to do the following : <ul style="list-style-type: none">- Enter 'Pairing' mode- Reset ZigBee Network
Wi-Fi Button	Use the Wi-Fi button to do the following : <ul style="list-style-type: none">- Enter 'Pairing' mode- Switch between cloud mode and AP mode (AP mode is currently not available)- Open WPS mode
Reset button	Use the reset button to do the following : <ul style="list-style-type: none">- Reset Gateway- Restart Gateway

Led Indicator

The Led Indicator status as below:

LED Status	What It Means
Purple LED Solid	Device initialization/searching for Wi-Fi connection
Purple LED Flashing	Device is in AP (default) mode (AP mode is currently not available)
Orange LED Flashing	Device has connected to the router
Blue LED Solid	Device is in 'Pairing' mode which means new ZigBee devices are allowed to join its network
Blue LED Flashing	Device is in cloud mode, connected to Maeви's cloud server and your Maeви app.
Orange LED and blue LED Flashing Alternately	ZigBee or Wi-Fi error
Blue LED Flashing	Device is in cloud mode, connected to Maeви's cloud server and your Maeви app.

Get Started

To get started, you will need :

- Maevi Gateway.
- A Wi-Fi Router with an Internet Access and 2.4GHz network enabled.
- Maevi Mobile App.

Then follow the steps below :

1. Insert the Maevi Gateway into a power socket. Turn it ON and wait for the purple LED light to start flashing purple (this means the gateway is in AP (default) mode).

TIP: If the LED indicator is not flashing purple, please reset the gateway to default factory settings by pressing and holding the reset button for 10 seconds.

2. Ensure your smartphone is connected to the Wi-Fi.
3. Configure your Gateway (**Refer to Configuration Gateway Steps**).

Configuration Gateway Steps

For Android User

1. Connect your smartphone to Wi-Fi (only supported 2.4GHz network), turn off mobile data and make sure on the device location.

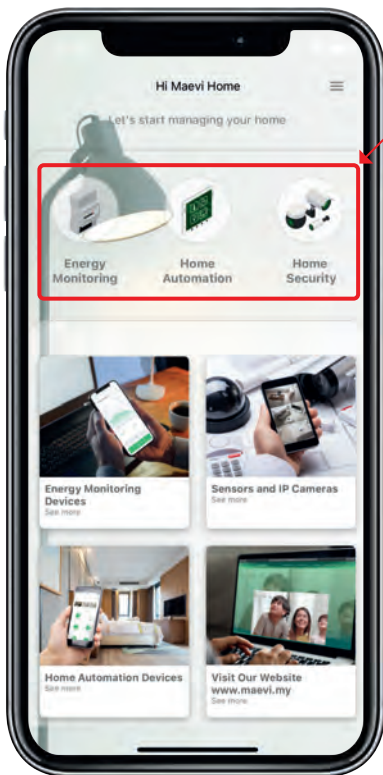

On Home Page,
tap **Home Automation/**
Energy Monitoring /
Security System
to configure Gateway



Select **Add Gateway**
to configure gateway

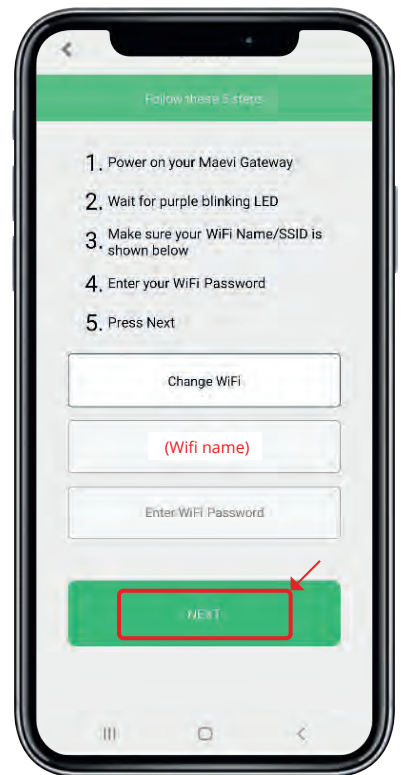

Choose Home Wi-Fi
Enter Wi-Fi Password
Tap **NEXT**

* Maevi Gateway does not
support 5GHz network



Select **Connect to Gateway** to connect with Maevi Gateway

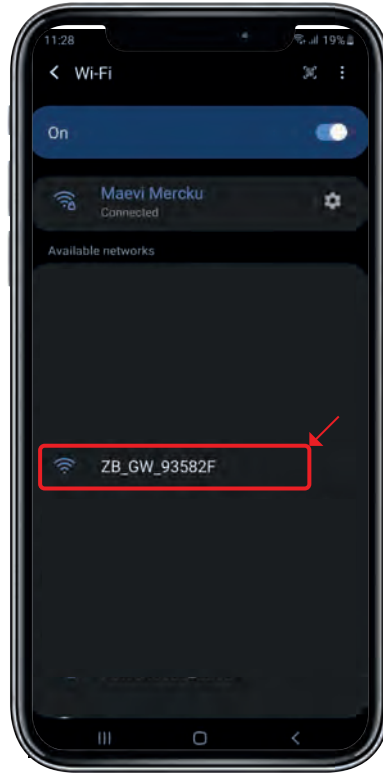

Select **"ZB_GW_"** to configure Maevi Gateway

*Ensure to select Keep Wi-Fi connection

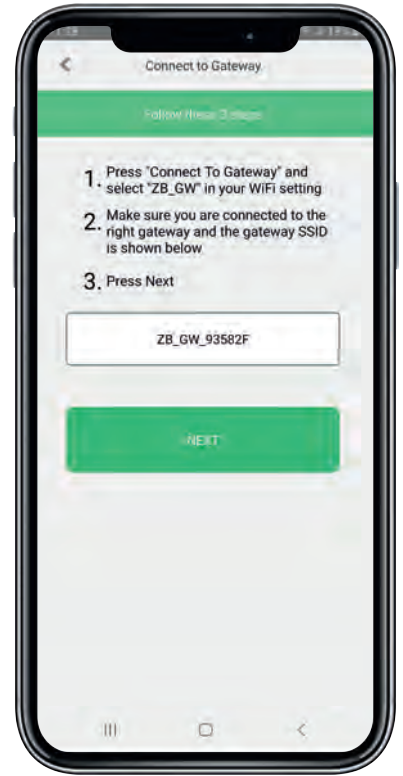

Make sure Gateway SSID appear in screen

Tap **NEXT**

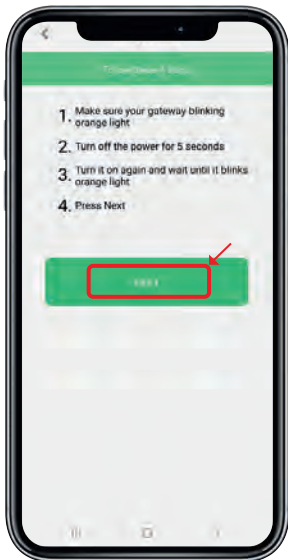

Follow above steps
Tap **NEXT**

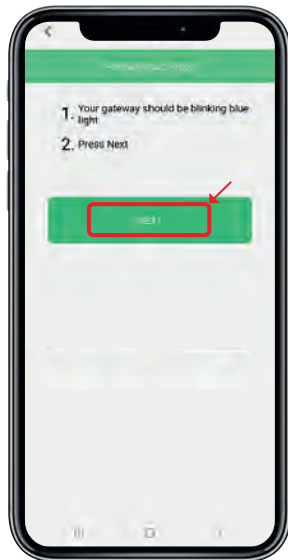

Follow above steps
Tap **NEXT**



Gateway configuration completed
Tap **NEXT**

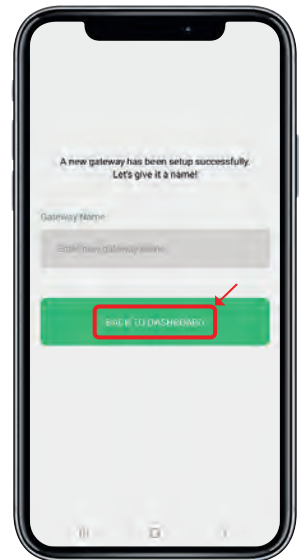

Name your Gateway Tap **BACK TO DASHBOARD**

Configuration Gateway Steps

For IOS User

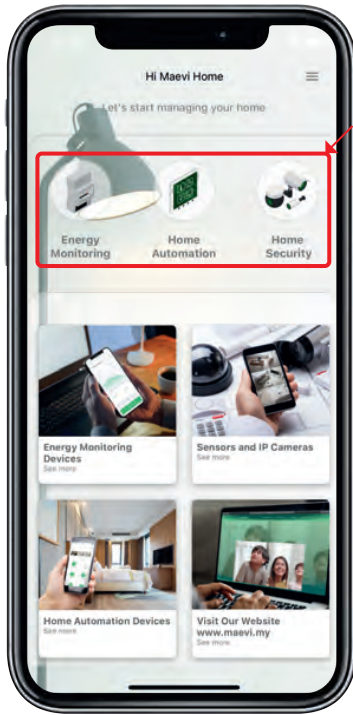

On Home Page, tap **Home Automation/ Energy Monitoring / Security System** to configure Gateway



Select **Add Gateway** to configure gateway

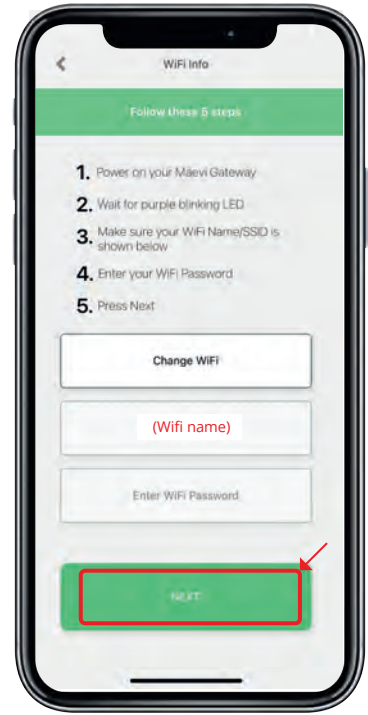

Choose Home Wi-Fi
Enter WiFi Password
Tap **NEXT**

*Maevi Gateway does not support 5GHz network

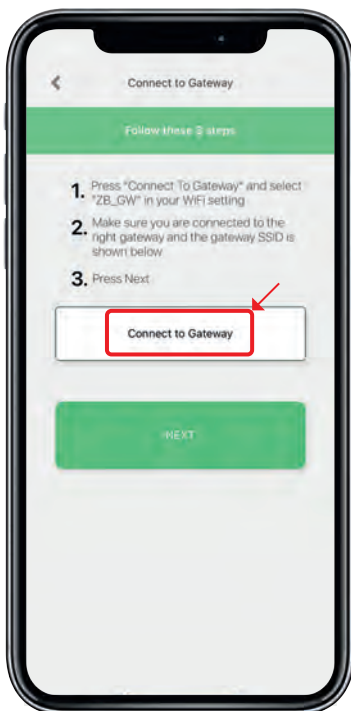

Select **Connect to Gateway** to connect with Maevi Gateway

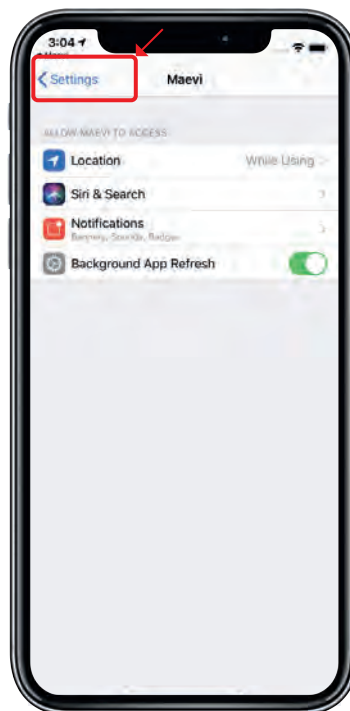

Select **Settings** to proceed

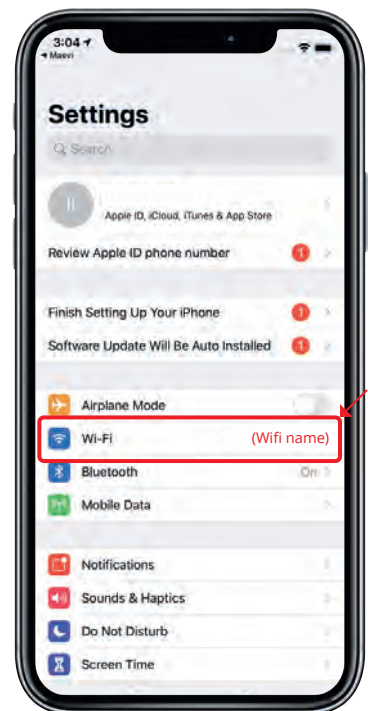

Select **Wi-Fi** to proceed



Select **ZB_GW_**
to proceed

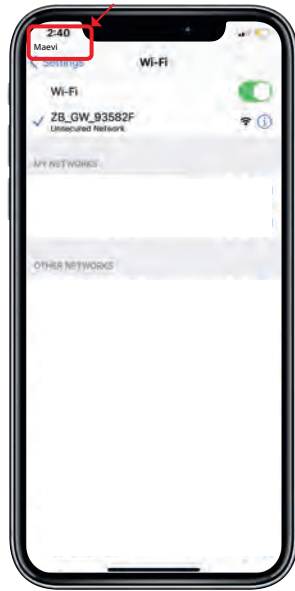

Return to **Maevi**
App – Top Left



Make sure
Gateway SSID
appear in screen
Tap **NEXT**

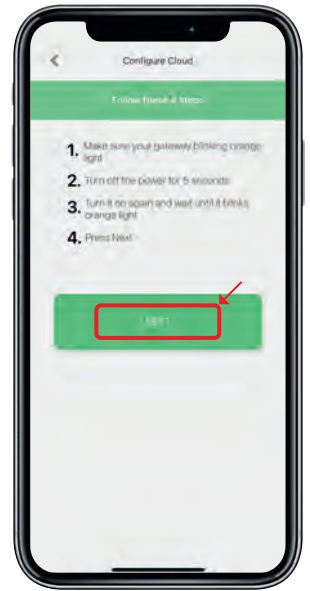

Follow above
steps
Tap **NEXT**

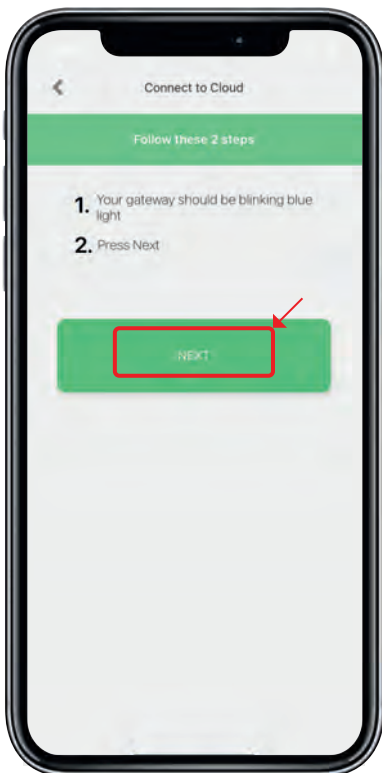

Follow above steps
Tap **NEXT**

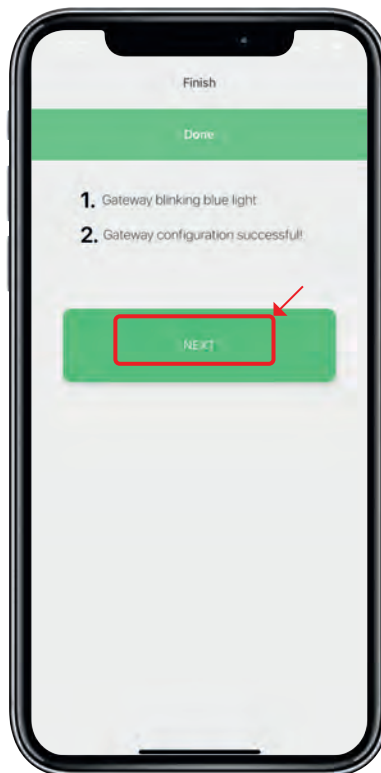

Gateway configuration
completed
Tap **NEXT**

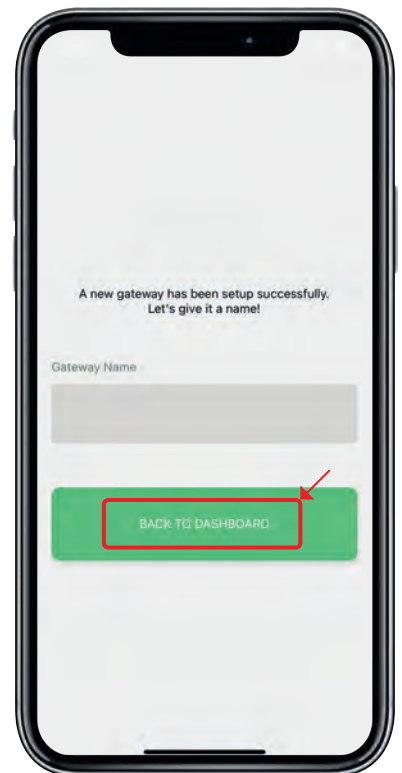

Name your Gateway
Tap **BACK TO
DASHBOARD**

Reset Gateway

Use a pin key tool to press and hold the reset button for 10 seconds until the LED indicator flashes purple.

ATTENTION: This will return the gateway to default factory settings, all the data stored including the Zigbee pairing information and Wi-Fi settings will be lost.

Reset Wi-Fi Network

1. Press the Wi-Fi button and the reset button (use a pin key tool) simultaneously to reset Wi-Fi network. If the reset is successful, the LED indicator will flash purple six times.
2. After resetting Wi-Fi network please refer **Configuration Gateway Steps** to restart.

Gateway Workaround

In case your Gateway configuration failed, this might happen due to the technology barrier between our Gateway and high-end routers. Here are two methods to configure Gateway for high-end routers.

Method 1 : Via Hotspot (imitate your home Wi-Fi Router)

You will need an additional smartphone for this method.

For Android User

1. Enable Mobile Hotspot.
2. Set up your mobile hotspot same as home Wi-Fi settings.
Rename the Hotspot Name and Password EXACTLY the same as Home Wi-Fi Name and Password.
3. Turn off the home Wi-Fi router.
4. Configure the gateway to the mobile hotspot that has been set up.
Refer to gateway configuration steps.
5. After successfully configured the gateway, rename the mobile hotspot name and password back to its default/different name.
The Gateway LED will flash BLUE upon successful configuration
6. Turn off mobile hotspot and gateway.
7. Turn on the home Wi-Fi router.
8. Turn on the gateway. The gateway LED should be flashing blue indicating it has successfully connected to your Wi-Fi router.

For IOS User

1. Enable Personal Hotspot.
2. Set up your personal hotspot same as home Wi-Fi settings.
Rename the Hotspot Name and Password EXACTLY the same as Home Wi-Fi Name and Password.
To Rename – Settings > General > About > Name
To Change Password - Settings > Personal Hotspot > Wi-Fi Password
3. Turn off the home Wi-Fi router.
4. Configure the gateway to the mobile hotspot that has been set up.
Refer to gateway configuration steps.
5. After successfully configured the gateway, rename the mobile hotspot name and password back to its default/different name.
The Gateway LED will flash BLUE upon successful configuration.
6. Turn off mobile hotspot and gateway.
7. Turn on the home Wi-Fi router.
8. Turn on the gateway. The gateway LED should be flashing blue indicating it has successfully connected to your Wi-Fi router

Method 2: Create Guest Wi-Fi Network (Refer to Wi-Fi manufacturer's manual for complete guide)

1. Enter your router's IP address into the search bar of any web browser.
2. Log into your router as admin.
3. Find the guest network settings.
4. Enable the guest Wi-Fi access.
5. Set the guest Wi-Fi network name and password.
6. Save your new Settings.
7. Configure gateway using the Guest Wi-Fi network **(Refer to gateway configuration steps)**.

maevi

Smart Gateway Guide



Visit our website for more info at maevi.my